

WINDOW AND PATIO DOOR HARDWARE

SASH LOCKS

Clamp Style

Furnished w/screws



CODE	MATERIAL	FINISH	PACK	INNER	MASTER
60903	Steel	Brass	Card	10◆	10
60902	Steel	Antique Brass	Card	10◆	100
96953	Steel	Brass	Polybag	50◆	500

Spring Action

Furnished w/screws

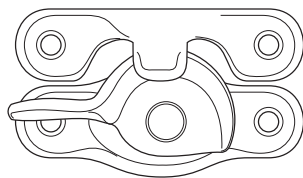

CODE	MATERIAL	FINISH	PACK	INNER	MASTER
46000	Zinc	Brass	Polybag	50◆	500

Furnished w/screws

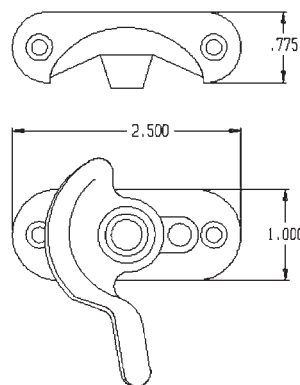

CODE	MATERIAL	FINISH	PACK	INNER	MASTER
46005	Steel	Brass	Polybag	50◆	400

Solid brass; Furnished w/screws

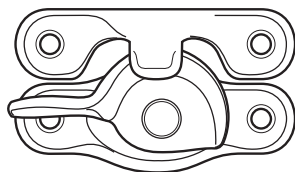

CODE	MATERIAL	FINISH	PACK	INNER	MASTER
46176	Solid Brass	Brass	Polybag	20◆	160
46175	Solid Brass	Polished Chrome	Polybag	20◆	160

Safety Tab

Squeeze locking tab; Furnished w/screws

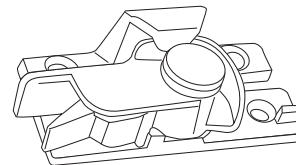

CODE	FINISH	PACK	INNER	MASTER
58157	Brass	Blister Card	12◆	120
58158	White	Blister Card	12◆	120

Cam-Action

Furnished w/screws

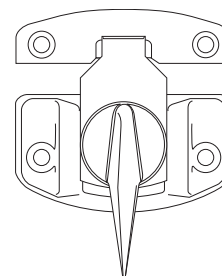

CODE	MATERIAL	FINISH	PACK	INNER	MASTER
60901	Steel	Brass	Card	10◆	100
46010	Steel	Brass	Polybag	50◆	250

WINDOW LOCKS

Key Operated

Furnished w/screws

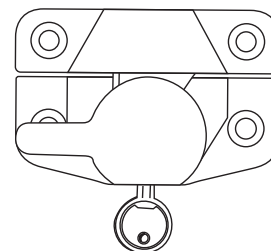
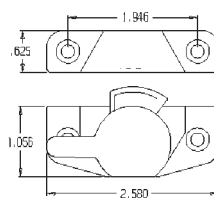

CODE	FINISH	KEYED	PACK	INNER	MASTER
46015	Brass	KA	Card	12◆	120

Window "Safe" Lock

Furnished w/screws

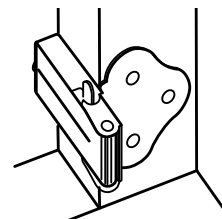

CODE	FINISH	PACK	INNER	MASTER
96980	Brass	Polybag	25◆	600

JALOUSIE OPERATORS

Fits all jalousie windows and doors; 4" Standard aluminum link arm; Hardened precision gears; 3-7/8" & 4-3/4" mounting hole centers; Staked on operating T-handle; Furnished w/screws

Standard Arm

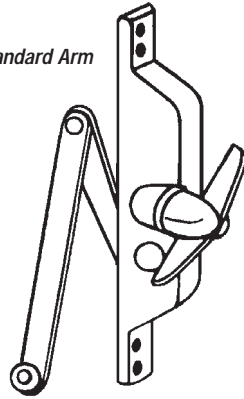

CODE	MATERIAL	FINISH	PACK	INNER	MASTER
53400	Zinc	White	Polybag	24◆	96
53401	Zinc	Aluminum	Polybag	6◆	96

Hardened precision gears; Fits all jalousie windows and doors; 3-7/8" and 4-3/4" Mounting hole centers; Staked on operating T-handle; Link arm not included; Packed w/o screws



CODE	MATERIAL	FINISH	PACK	INNER	MASTER
53402*	Zinc	White	Polybag	24◆	96

JALOUSIE OPERATOR KIT

For all jalousie type windows & doors; Kit Includes: 1 Universal operator with attached T-handle, 4 Machine screws, 4 Nuts, 1 Calibrated arm for lengths of 3", 3-1/2", 4" & 4-1/2", 1 Link screw, 1 Shoulder screw, 1 Nylon bushing, 4 Sheet metal screws

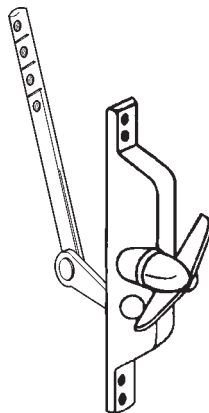

CODE	MATERIAL	FINISH	PACK	INNER	MASTER
41100	Zinc	Aluminum	Card	6◆	48
41105	Zinc	White	Card	6◆	198

AWNING WINDOW OPERATORS

Replaces most popular type operators; 3/8" Gear bore & 3-1/2" link arm; Furnished w/ connecting link, crank handle, & screws

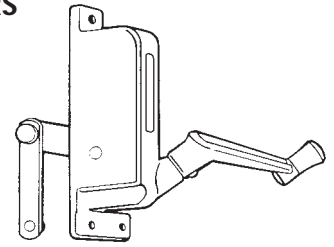

Left Hand shown

CODE	MATERIAL	FINISH	HAND	PACK	INNER	MASTER
53450	Zinc	Aluminum	Left	Polybag	6◆	36
53455	Zinc	Aluminum	Right	Polybag	6◆	36

CASEMENT WINDOW FASTENER

Full 360° swivel handle; Overall plate size: 1-1/2"w x 7/8"h; 9/16" Throw; Furnished w/screws and surface keeper

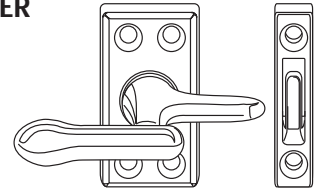

CODE	MATERIAL	FINISH	PACK	INNER	MASTER
27110	Solid Brass	Brass	Polybag	20◆	160

Full 360° swivel handle; Overall plate size: 1-1/8"W x 2"H; 9/16" Throw; Furnished w/ two keepers, one surface, one mortise & screws

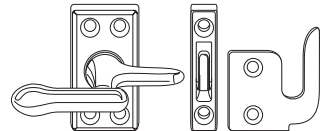

CODE	MATERIAL	FINISH	PACK	INNER	MASTER
27100	Zinc	Brass	Polybag	5◆	200

CASEMENT WINDOW OPERATORS

Arm movement of 105° arc; Hardened gear casing; Rustproof steel 9" long operating arm; Furnished w/screws

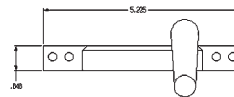
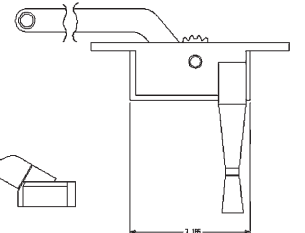

CODE	MATERIAL	FINISH	HAND	PACK	INNER	MASTER
53500	Zinc	Bronze	Left	Card	6◆	48
53505	Zinc	Bronze	Right	Card	6◆	48

* = Discontinued - While Supplies Last

CASEMENT WINDOW ADJUSTERS

Heavy gauge; Knurled thumb turn knob locking mechanism; 3/8" Thick arm with swivel end bracket; Adjustable openings up to 90°; Furnished w/ installation screws

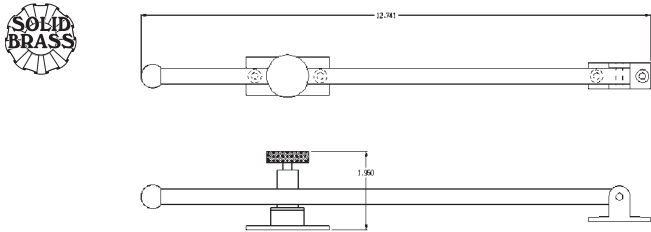

CODE	MATERIAL	SIZE	FINISH	PACK	INNER	MASTER
01790	Solid Brass	10"	Brass	Polybag	3◆	48
01795	Solid Brass	12-1/4"	Brass	Polybag	12	48

WINDOW LIFT

2-Hole screw mount; Overall size: 1-11/16" x 1-5/16"; Furnished w/screws



CODE	MATERIAL	FINISH	PACK	INNER	MASTER
43314	Solid Brass	Brass	Polybag	50◆	400

SASH LIFT

4 Hole screw mount; Furnished w/screws

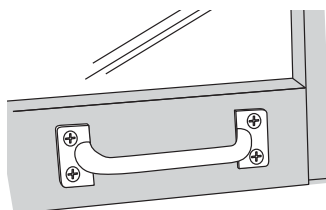

CODE	MATERIAL	SIZE	FINISH	PACK	INNER	MASTER
60904	Zinc	4"	Brass	Card	5◆	100
60905	Zinc	4"	Antique Brass	Card	5◆	100

SOLID BAR PULL HANDLE — OR SASH LIFT

Features 4-hole screw mounting; Furnished w/screws

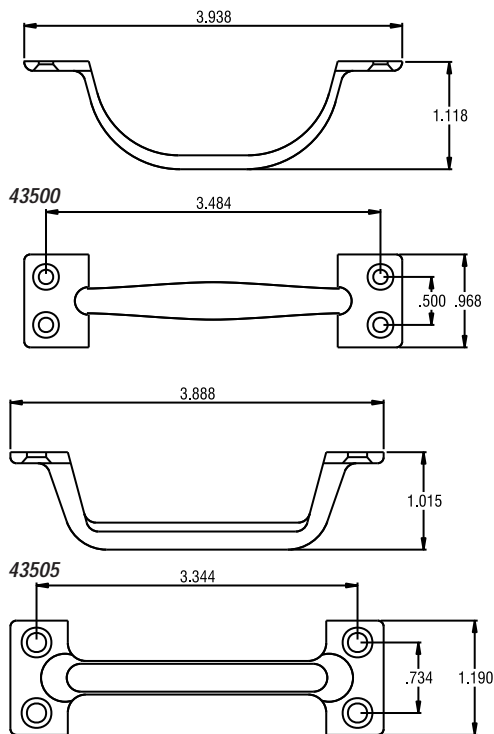

CODE	MATERIAL	SIZE	FINISH	PACK	INNER	MASTER
43500	Zinc	4"	Brass	Polybag	25◆	600
43505	Zinc	4"	Brass	Polybag	50	400

SLIDING DOOR FLUSH PULLEY

Face plate overall size: 4-1/2"L x 1"W; Wheel diameter: 2-1/32"



CODE	MATERIAL	FINISH	PACK	INNER	MASTER
97168	Steel	Zinc	Bulk	20◆	200

WINDOW SASH TENSION SPRING

For double hung windows; Rust resistant heavy gauge steel; Replaces broken sash cord



CODE	MATERIAL	FINISH	PACK	INNER	MASTER
68500	Steel	Zinc	Card	12◆	240

SECURITY NIGHT LOCK PINS

For sliding aluminum patio doors; 1/4" Diameter knurled head; Case hardened; Furnished w/ 7-1/2" nickel plated link chain, hanger, bracket, retainer cap and screw; Overall length: 3-3/8"

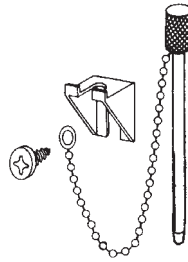

CODE	FINISH	PACK	INNER	MASTER
57000	Nickel	Polybag	100◆	1200

SHUTTER HARDWARE

4 Panel Shutters Hardware Set

Set includes 4 mounting hinges, 36 screws, 1 latch with 2 screws, 2 knobs with 2 screws, 4 interpanel hinges, hook/eye & pull knob

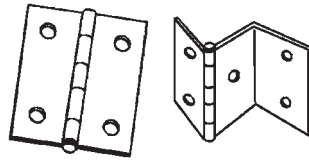

(Qty. 4)

(Qty. 4)

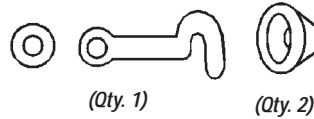

(Qty. 1)

(Qty. 2)

CODE	FINISH	PACK	INNER	MASTER
66000	Brass	Polybag	6◆	96

Shutter Hinges

Furnished w/screws; Sold in pairs

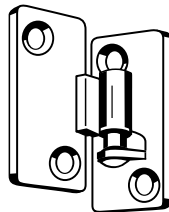

CODE	FINISH	PACK	INNER	MASTER
96737	Zinc	—	12◆	120

TRACK LOCKS

Fits all sliding metal door and window frames; Thumb screw locking



CODE	FINISH	PACK	INNER	MASTER
48000	Aluminum Mill	Bulk	100◆	1200

Vinyl Lining

Contains wear resistant vinyl to prevent scratching

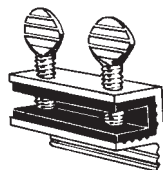

CODE	FINISH	PACK	INNER	MASTER
46103	Aluminum	Card	12◆	288
46112	Aluminum	Polybag	50◆	500

Vice-Like Grip

Vise-like grip prevents prying window or door open

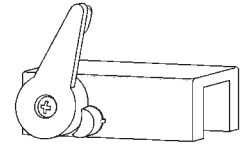

CODE	FINISH	PACK	INNER	MASTER
48002	Aluminum	Card	12◆	96

Plunger Type

Push button cylinder locking operation; 3/8" Hole required for bolt; Easily locked by pushing in cylinder; Furnished w/screws



CODE	KEYED	FINISH	PACK	INNER	MASTER
44913	KA	Aluminum	Card	6◆	120

SLIDING PATIO DOOR FOOT LOCK

Step-lock; Locks in open position

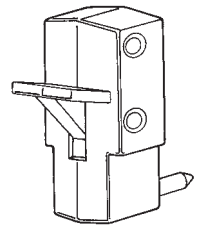

CODE	MATERIAL	FINISH	PACK	INNER	MASTER
45000	Zinc	Aluminum	Card	12◆	192

SLIDING DOOR BAR LOCKS

Makes all sliding glass doors jimmyproof; Self-storing; Fits up to 48" wide; Swings 90° & folds out-of-the way when not in use; Overall length 48" long with end cap; 5/8" Square extruded aluminum tubing; Easily cut with hacksaw to fit narrow doors & windows; Furnished w/ installation hardware pack and hinge bracket

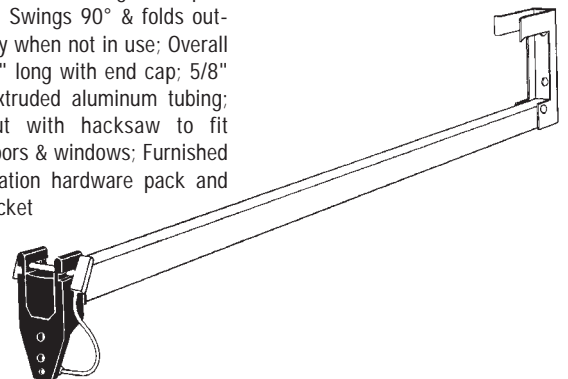

CODE	MATERIAL	FINISH	PACK	INNER	MASTER
44900	Aluminum	Satin	Blister Card	12	—
44905	Aluminum	White	Blister Card	12	—
44910	Aluminum	Bronze	Blister Card	12	—
44901	Aluminum	Satin	Bulk	24◆	—

REPLACEMENT KIT

99095	Aluminum	—	Polybag	1	500
-------	----------	---	---------	---	-----

PATIO DOOR LOCKS

Flush mount; 7-1/4" L x 7/8" W with 6-5/8" hole centers; Fits 7" cut-out; Outside with knock-out plug; Furnished w/ installation screws & standard lock keeper; 2 Keys w/ keyplug

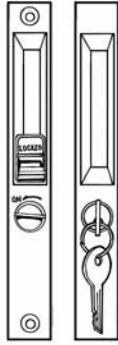

CODE	MATERIAL	TYPE	FINISH	PACK	INNER	MASTER
------	----------	------	--------	------	-------	--------

NITE LATCH

44871	Zinc	w/o Keyplug	Chrome	Box	1	96
44881	Zinc	w/o Keyplug	Chrome	Box	1	96
44878	Zinc	w/o Keyplug	Black	Box	1	96

NO LATCH

44873	Zinc	w/Keyplug	Chrome	Box	1	96
44870	Zinc	w/Keyplug	Chrome	Box	1	96

KEY PLUG CYLINDER

Fits sliding door locks: Codes 44873, 44871, 44881, 44878, & 44870; Tailpiece: 1/8" diameter; Wafer cylinder; Furnished w/ 2 keys

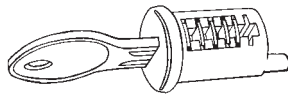

CODE	KEYED	KEYWAY	O.D.	PACK	INNER	MASTER
58420	KD	B-1	1"	Polybag	10♦	750
58422	KD	B-1	1-1/8"	Polybag	10♦	750

PATIO DOOR LOCK KEEPER

Fits most patio locks; Adjustable with elongated holes; 2-3/4" long x 3/4" wide; Furnished w/screws



CODE	MATERIAL	FINISH	PACK	INNER	MASTER
41021	Zinc	Chrome	Polybag	50♦	1000

MORTISE BODY LOCK

Backset 0.10"; Furnished w/screws and strikes

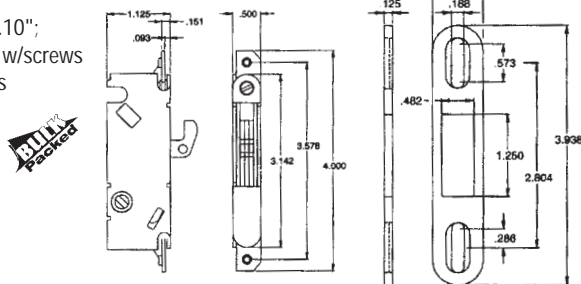

CODE	MATERIAL	FINISH	PACK	INNER	MASTER
44624	Steel	Zinc	Bulk	50♦	100

SCREEN DOOR LOCK

Outside pull, inside lock and keeper

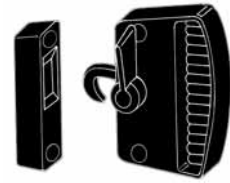

CODE	SIZE	FINISH	PACK	INNER	MASTER
45006	1-3/4" W x 3" L	Black	Card	12♦	96

SLIDING DOOR PULLS

Zinc die cast mounting brackets; Weather resistant finish; Fits most patio doors; Furnished w/ installation screws

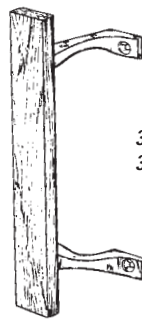

31608
31621

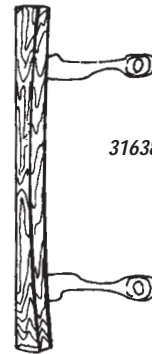

31638

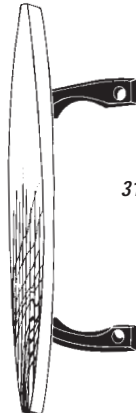

31626

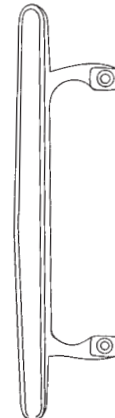

31622
One Piece
Construction

CODE	HANDLE	O.L.	HOLE CENTER	PACK	INNER	MASTER
31608	Teakwood	9"	6-5/8"	Card	12♦	96
31621	Teakwood	9"	6-5/8"	Polybag	12♦	96
31638	Teakwood	10"	6-5/8"	Polybag	10♦	60
31626	Teakwood	11"	6-5/8"	Polybag	10♦	60
31622	Chrome	10"	6-5/8"	Polybag	12♦	96